

FASTENER INSERTION MACHINES

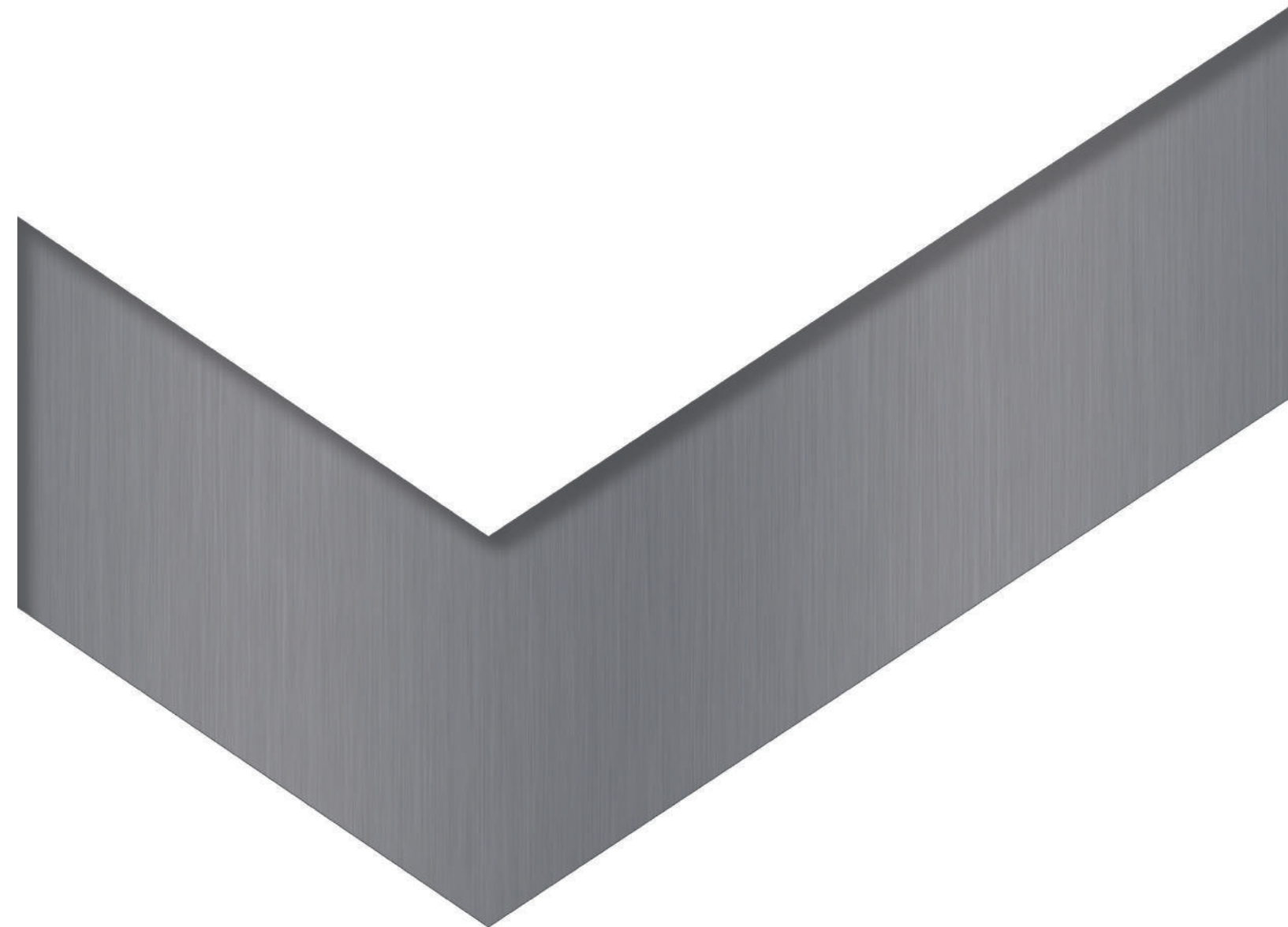

FASTENER INSERTION MACHINES

Quality, efficiency, damage reductions, labour saving

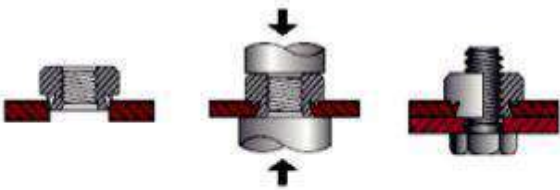

Fasteners utilize self-clinching, broaching, flaring, surface mount, technology to provide strong, reusable, and permanent threads and mounting points in thin sheet metal, P.C. board materials, and other ductile or non-ductile thin material.

Insertion machine is not a part of the manufacturing process where manufacturers want to invest a great deal of human resources. It is often monotonous work and can dramatically impact on production line **quality** and **efficiency**. The machine optimize **labor**, improve quality and increase productivity. The insertion machine also reduce part handling and part damage, and can be also customized to suit highly specialized applications.



FASTENER INSERTION MACHINES

Efficiency +30%

Quality 100%

CE standard



Machine Basic Features:

- The re-design rigid frame structure to eliminate the deformation during insertion press
- Easy to operate, humanized design pattern choice
- 100% pressure safety system
- Use all CE standard of electric, hydraulic, pneumatic components
- RSM special design and precision machining of oil cylinder to ensure long-term stability even in poor working environment
- Hydraulic system adopt Taiwan Winner valve group ensure high reliability work 24 hours a day, according to the high pressure value stable repeat work requires the freedom to choose the dwell time ensure insertion 100% qualified
- Can be equipped with automatic feeding system, clinching joint system



TECHNICAL FEATURES

PRESSURE DURING THE WHOLE TRIP- Pressure on the any point of processing, security system can use, and the system does not need to make any adjustment, it does not increase the time of device initialization and tool change setting.

ENERGY SAVING AND ENVIRONMENT PROTECTION-Hydraulic drive can reduce Energy consumption by about 40% relatively pneumatic and hydraulic drive, greatly reducing the Energy costs of equipments, the machine only press instantly applied in the full-load, standby power consumption is only 15%.

J TYPE HOOK BRACKET(MSTP 33 PIECES OF HAND TOOLS)-J-hook realized insertion after bending, allowing you to bending easier.

EASY OPERATION-Proprietary stress test adjustment button,allowing you to find the right riveting pressure within 10 seconds the novice can easily operate.

FORWARD LIMITED-Forward limited is specifically designed for the soft material, such as: PC board, plastic, glass and aluminium, which make fasteners plates will not be deformed or crusche.

CUSTOMIZED DESIGN AND DEVELOPMENT-RSM has professional technical team, to produce special pieces suitactual production customized tools for customer to solve production problems all insertion.



J TYPE HOOK BRACKET

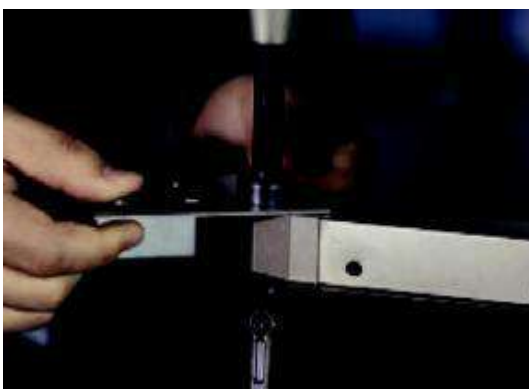

Pressure
Gauge/Force
in dicator



Figure 5.4: Turn clockwise to increase Pressure/Force the pressure, counterclockwise to decrease Adjustment Control decrease

SAFETY SYSTEM



SAFE AND RELIABLE-Security system of Fastener Insertio Machine make the operator to full protection on the conductive non-conductive work mode, which greatly enhanced the confidence and plug efficiency for the operator. No security risk

- Allow the operator to work fast and safety without use of protections.
- No lost of time due to the adjust of the safety system.
- The safety function is independent from the machine work.
- It is possible to adjust the power during the work without interfere with the safety system;The start of the working cycle is by pedal.
- Safety on the apply a constant and correct fastener power.
- Adjustable power in every point of the cylinder stroke.

*This picture demonstrates the anti-pressure hand function of the machine refers to the special security mode of processing, only for reference, prohibited imitation.

ON SWITCH & LIGHT

OFF SWITCH

RUN/SETUP SELECTOR SWITCH SET UP POSITION

MODE SELECTOR SWITCH NON-CONDUCTIVE POSITION

VACUUM GENERATOR ON/OFF SWITCH
O Off | On



RUN/SETUP SELECTOR SWICH RUN POSITION

MODE SELECTOR SWITCH CONDUCTIVE MODE

UP TRAVEL CONTROL

DWELL CONTROL

TECHNICAL SPECIFICATION

	416 PLUS	618 PLUS	824 PLUS
Force	44Kn(4.4 Tons)	54Kn(5.4 Tons)	72Kn(7.2 Tons)
Throat Depth	16" (406mm)	18" (450mm)	24" (610mm)
Throat Height	13" (340mm)	15" (381mm)	17" (421mm)
Stroke Length Adjustable	Yes	Yes	Yes
Numbers Of Inserts Per Hour(Manually)	1200	1200	1200
Ram Force Repeat Accuracy	+/-1%	+/-1%	+/-1%
Safety Device	Yes	Yes	Yes
Manual Turret Insertion System(Optional)	Yes	Yes	Yes
Automatic Feeding System(Optional)	No	Yes	Yes
Clinching Joint System(Optional)	Yes	Yes	Yes
Dwell time	No	Standard	Standard
Forward Limited	No	Option	Option
Batch Counter(Optional)	No	Yes	Yes
Main power	1.5kw	2.2kw	3.75kw
Tank Capacity	10 gallons (38 liters)	10 gallons (38 liters)	20 gallons (38 liters)
Power Supply	220V	380V	380V
	single phase 50HZ	3 phase 50HZ	3 phase 50HZ
Dimension(W×D×H)	29" × 33" × 65" (740mm × 840mm × 1650mm)	31" × 32" × 83" 800mm × 810mm × 2100mm	40" × 38" × 98" 1025mm × 960mm × 2500mm
Net Weight	739 lbs. (335Kg)	1346 lbs. (610Kg)	2096 lbs. (950Kg)

Main parts	Origin
Valves	Made in Taiwan(Winner)
Cylinder	Made in China
Pump	Made in Taiwan
Relays	Made in France(Schneider)

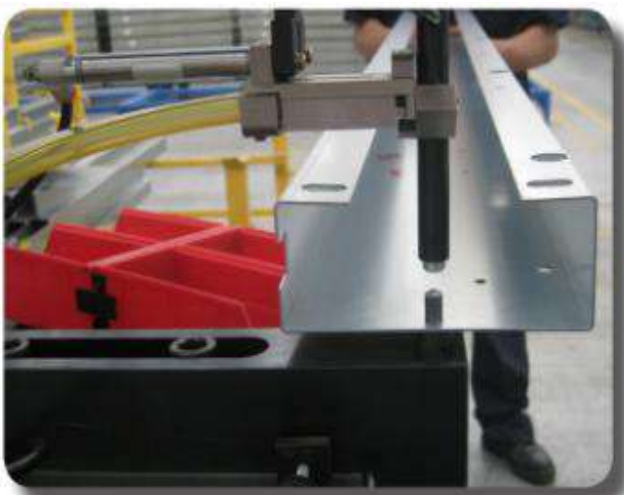

416 Plus

Main Feature:

- High stiffness, structure, high stability, less deformation, less vibration, high accuracy
- Ergonomic design frame and different size tooling package with easy operation panel to meet most of the complex insertion process by single operator
- Quick press force setting and repeatability +/-1%
- Force range MAX 44KN
- Throat depth 406 mm
- 100% safety system
- Energy saving re-design reliability and energy efficiency of a full hydraulic system
- Noise reduced to 35db
- Possibility to insert M8 nut with the mild steel
- Equipped with standard tooling storage
- Blue & white color
- Standard power supply 1 phase 220v/50hz



Machine Order Number

Item	Part Num.	Description
1	S-000300 BW	416 Plus
2	S-000364	MSTP 33 pieces Metric Standard Tooling Package/33



618 Plus

Main Feature:

- High stiffness, structure, high stability, less vibration, high accuracy
- Ergonomic design frame and different size tooling package with easy operation panel to meet most of the complex insertion process by single operator
- Quick press force setting and repeatability +/-1%
- Ram force range MAX 54KN
- Throat depth 458 mm
- 100% safety system
- Energy saving re-design reliability and energy efficiency of a full hydraulic system
- Optional auto feeding system and clinching joint system
- Possibility to insert M10 nut with the mild steel
- Blue & white color
- Standard power supply 3 phase 380v/50hz



Machine Order Number

Item	Part Num.	Description
1	S-000300 BW S-000306 BW	618 Plus 618 Plus with Forward Limited
2	S-000364	MSTP 33 pieces Metric Standard Tooling Package/33
3	S-X-X S-000440	Automatic tooling set Autofeed modular

824 Plus

Main Feature:

- High stiffness, structure, high stability, less vibration, high accuracy
- Ergonomic design frame and different size tooling package with easy operation panel to meet most of the complex insertion process by single operator
- Quick press force setting and repeatability +/-1%
- Ram force range MAX 72KN
- Throat depth 610 mm
- 100% safety system
- Energy saving re-design reliability and energy efficiency of a full hydraulic system
- Standard Tooling Protection System
- Optional auto feeding system and self-clinch tooling
- Possibility to insert M12 nut with the mild steel
- Variable dwell time for use stainless steel M8 nut and materials and the others hard materials
- Blue & white color
- Standard power supply 3 phase 380v/50hz



Machine Order Number

Item	Part Num.	Description
1	S-000309 BW	824 Plus
2	S-000364	MSTP 33 pieces Metric Standard Tooling Package/33
3	S-X-X S-000440	Automatic tooling set Autofeed modular

Options

MSTP-Manual Tooling Package

33 pieces of manual work with nuts, studs & standoff different size of punch and dies M2-M8, length up to 35mm, special insertion application for small parts flange die holder and Manual J frame.



Modular autofeed system

-Including high quality vibration bowl and intelligent digital variable voltage and variable frequency Piezoelectric vibration feeder controller.

-Single and constant working mode

-Integrate Vacuum generator

-Work with nuts, studs & standoff size M2-M12, length up to 30mm



33 pieces Metric Standard Tooling Package



Main contains:

S-000296	Trunk Base	S-000066	76mm M2.5 Nut tooling
S-000295	J-Frame Crook	S-000067	76mm M3 Nut tooling
S-000011	Plat Lower Die	S-000068	76mm M3.5 Nut tooling
S-000079	M2.5 Nut J-Frame Crook tooling	S-000069	76mm M4 Nut tooling
S-000080	M3 Nut J-Frame Crook tooling	S-000070	76mm M5 Nut tooling
S-000081	M3.5 Nut J-Frame Crook tooling	S-000071	76mm M6 Nut tooling
S-000082	M4 Nut J-Frame Crook tooling	S-000072	76mm M8 Nut tooling
S-000083	M5 Nut J-Frame Crook tooling	S-000146	76mm M3 Stud tooling
S-000084	M6 Nut J-Frame Crook tooling	S-000145	76mm M3.5 Stud tooling
S-000141	M3 Stud J-Frame Crook tooling	S-000147	76mm M4 Stud tooling
S-000142	M3.5 Stud J-Frame Crook tooling	S-000148	76mm M5 Stud tooling
S-000143	M4 Stud J-Frame Crook tooling	S-000149	76mm M6 Stud tooling
S-000144	M5Stud J-Frame Crook tooling	S-000150	76mm M8 Stud tooling
S-000152	38mm Long Plat Die	S-000155	76mm M3 Standoff tooling
S-000151	76mm Long Plat Die	S-000156	76mm M3.5 Standoff tooling
S-000154	38mm Large Plat Die	S-000157	76mm M4/M5 Standoff tooling
S-000153	76mm Large Plat Die		

Options

TIS-Turret Insertion System

Multiple manual insertion system turret complete with 4 boxes that match with different anvil



Batch Counter



Consists of independeng 3 counters and a electronic beepers for audible signals, Set and display the number remaining to be insert in the Workpiece

Forward Limited



Forward Limited function is designed to protect both the tooling and the workpiece from damage by positive stop cylinder

Lazer locating light



Assist to handling the big workpiece to cover lower tool by lazer locating light reference

Shuttle nut tooling system

618Plus & 824Plus

Captive:C, CS
 PEM: S, SS, CLS, CLSS
 TR: TR-S, TR-CLS
 PSM:P-S, P-CLS



Notes:

1. Please specify your fastener size and supply min 300 PCS samples to RSM for testing and design the automatic tooling
2. A one time purchase of a Shuttle Nut Controller, T-Bracket, and Vacuum Generator is included for Shuttle Nut Tooling set
3. Please specify machine model and serial number when ordering SHUTTLE TOOLING SET as a retrofit item
4. CLA, CA Aluminum nuts are MADE TO ORDER TOOLING (Aluminum nuts are larger than steel nuts) Standard tooling will need to be modified

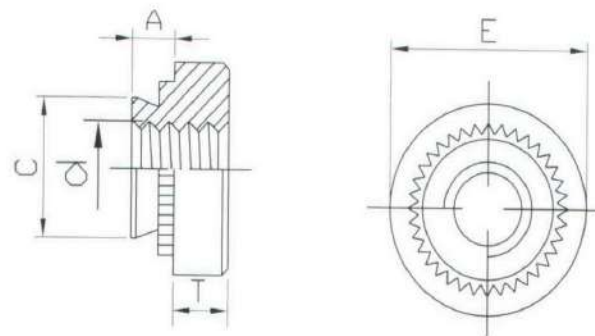

Nut Automatic Tooling System Part Num.

FASTENER SIZES(mm)	Shuttle Tooling Set	Shuttle Nut Controller	AUTOFEED MODULAR
NUTS			
S-M3-0,1,2	S-000354-3	S-000224	S-000440
S-M4-0,1,2	S-000354-4	S-000224	S-000440
S-M5-0,1,2	S-000354-5	S-000224	S-000440
S-M6-0,1,2	S-000354-6	S-000224	S-000440
MX-0,-1,-2(Special request)	S-000354-X	S-000224	S-000440

Bottom feed nut tooling system

618Plus & 824Plus

Captive:C, CS
 PEM: S, SS, CLS, CLSS
 TR: TR-S, TR-CLS
 PSM:P-S, P-CLS



Notes:

1. Please specify your fastener size and supply min 300 PCS samples to RSM for testing and design the automatic tooling

2. Please specify machine model and serial number when ordering a vacuum generator as a retrofit item

3. CLA, CA Aluminum nuts are MADE TO ORDER TOOLING (Aluminum nuts are larger than steel nuts) Standard tooling will need to be modified for aluminum fasteners



Bottom Feed Nut Automatic Tooling System Part Num.

FASTENER SIZES(mm)	BOTTOM FEED NUT TOOLING SET	AUTOFEED MODULAR
NUTS		
S-M3-0,1,2	S-000350-3	S-000440
S-M4-0,1,2	S-000350-4	S-000440
S-M5-0,1,2	S-000350-5	S-000440
S-M6-0,1,2	S-000350-6	S-000440
MX-0,-1,-2(Special request)	S-000350-X	S-000440

Shuttle standoff/stud tooling system

618Plus & 824Plus

Captive:C, CS
PEM: S, SS, CLS, CLSS
TR: TR-S, TR-CLS
PSM:P-S, P-CLS



1. Please specify your fastener size and supply min 300 PCS samples to RSM for testing and design the automatic tooling

2. A one time purchase of T-Bracket, and Vacuum Generator is included for Shuttle standoff Tooling set

3. Please specify machine model and serial number when ordering a Vacuum Generator as a retrofit item

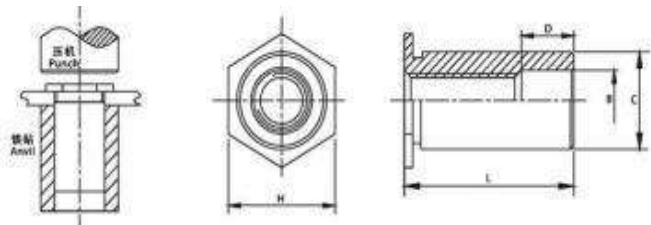

Shuttle standoff/stud tooling system



Stud Automatic Tooling System Part Num.

FASTENER SIZES(mm)	SHUTTLE TOOLING SET	AUTOFEED MODULAR
FLUSH-HEAD STUDS		
FH-M3-8~25	S-000098-12	S-000440
FH-M4-8~25	S-000098-13	S-000440
FH-M5-15~25	S-000098-14	S-000440
MX-0,-1,-2(Special request)	S-000098-X	S-000440

Captive:CH, CHS,CHA

PEM: FH,FHS,FHA

TR: TR-FH, TR-FHS

PSM:P-FH, P-FHS

Standoff Automatic Tooling System Part Num.

FASTENER SIZES(mm)	SHUTTLE TOOLING SET	AUTOFEED MODULAR
THRU-HOLE THREAD STANDOFFS		
SO-M3-8~25	S-000098-3	S-000440
SO-3.5M3-8~25	S-000098-5	S-000440
SO-M4-8~25	S-000098-7	S-000440
SO-M5-8~25	S-000098-9	S-000440
MX-0,-1,-2(Special request)	S-000098-X	S-000440

Captive:CFSO.CFSOA,CFSOS

PEM: SO,SOA,SOS

TR: TR-SO,TR-SOS,TR-SOA

PSM:P-SO,P-SOS,P-SOA

Blind Standoff Automatic Tooling System Part Num.

FASTENER SIZES(mm)	SHUTTLE TOOLING SET	AUTOFEED MODULAR
BLIND THREAD STANDOFFS		
BSO-M3-8~25	S-000098-3	S-000440
BSO-3.5M3-8~25	S-000098-5	S-000440
BSO-M4-8~25	S-000098-7	S-000440
BSO-M5-8~25	S-000098-9	S-000440
MX-0,-1,-2(Special request)	S-000098-X	S-000440

Captive:CFBSO.CFBSOA,CFBSOS

PEM: BSO,BSOA,BSOS

TR: TR-BSO,TR-BSOS,TR-BSOA

PSM:P-BSO,P-BSOS,P-BSOA

RSM Clinch Joint System



Are you still Welding or Riveting?

SAVE MONEY-Join your parts with a Punch and Die!
RSM and BTM related clinching tools join sheet metal without the expense of welding or purchased fasteners by simply joining the part's own material! Assembly cost is significantly reduced by drawing and forming the part material into and interlock. Join galvanized, pre-painted, or even dissimilar metal combinations using an environmentally friendly process that does not produce sparks, harmful fumes or damaging heat!

Some Benefits of BTM's Clinching Solutions:

- RSM Clinch Joints system are consistently strong
- RSM Clinch Joints are Non-destructively checked
- RSM Clinching is fast(a joint can typically be created in under one second)

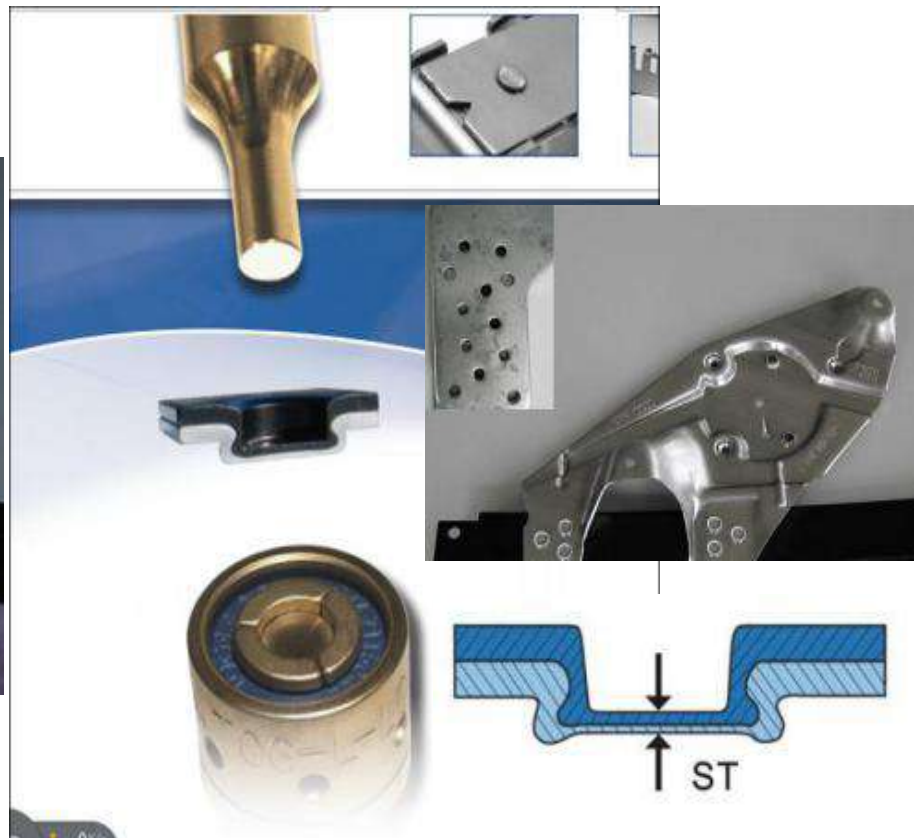

RSM Joint BTM Tooling Set order specification Request

1. Please specify your joint parts material, drawing and supply min 10 pcs samples to RSM for define BTM joint tooling.

A one time purchase of BTM Punch, die and punch/die holder is included for RSM Joint BTM Tooling Set

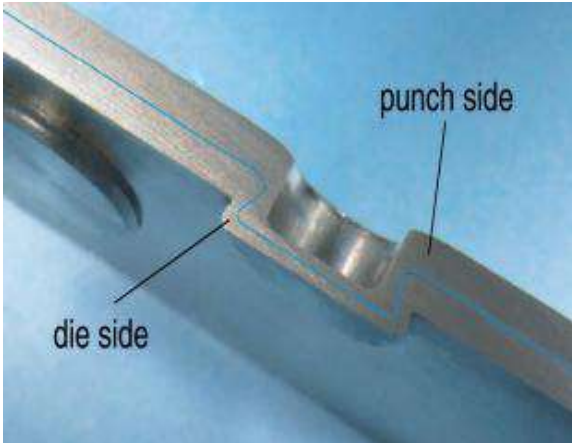

Self clinch mechanical joint tooling set for mild steel sheet thickness from 0.6mm to 2.5mm, for Stainless steel sheet thickness on request.

JOINT TOOLING	PART NUMBER	SHEET MATERIAL	STRENGTHEN	THICKNESS
PUNCH	S-BTM182	MS <input type="checkbox"/> SS <input type="checkbox"/> AL <input type="checkbox"/>		
DIE	S-BTM183	MS <input type="checkbox"/> SS <input type="checkbox"/> AL <input type="checkbox"/>		
PUNCH/DIE HOLDER SET	S-BTM181			

Please specify RSM Joint Minium Distance Request

A	B	C	D	E

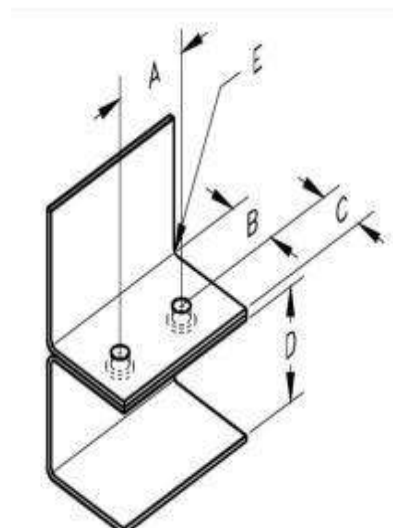

MECOS

DEFORMACIÓN DEL METAL

Mecos Ibérica, s.l
c/Albert Einstein, nº 6
08940 Cornellá
T/ 934 740 771
mecos@mecosiberica.es
www.mecos.es